

NOTES:

1. DEFINED FLOOD LEVEL RL 37.25 AHD.
2. PADMOUNT SUBSTATION RL 37.3 AHD.
3. FOR ALL ENERGEX RELATED CONSTRUCTION QUERIES THE ELECTRICAL DESIGN GROUP ON (07) 3278 4375 IS THE FIRST POINT OF CALL.
4. THERE ARE NO BUILDINGS WITHIN 20m OF THE PADMOUNT SUBSTATION.
5. THERE ARE NO HYDRANTS WITHIN 20m OF THE PADMOUNT SUBSTATION.
6. THERE ARE NO TELSTRA / NBN PITS OR PILLARS WITHIN 2m OF THE PADMOUNT SUBSTATION.

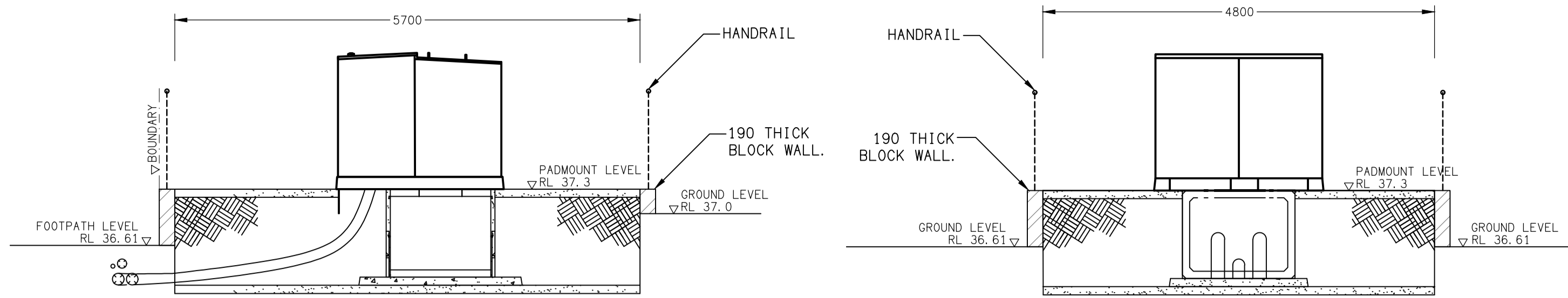

DETAIL A
PADMOUNT SECTION VIEW
SCALE 1:50

DETAIL B
PADMOUNT SECTION VIEW
SCALE 1:50

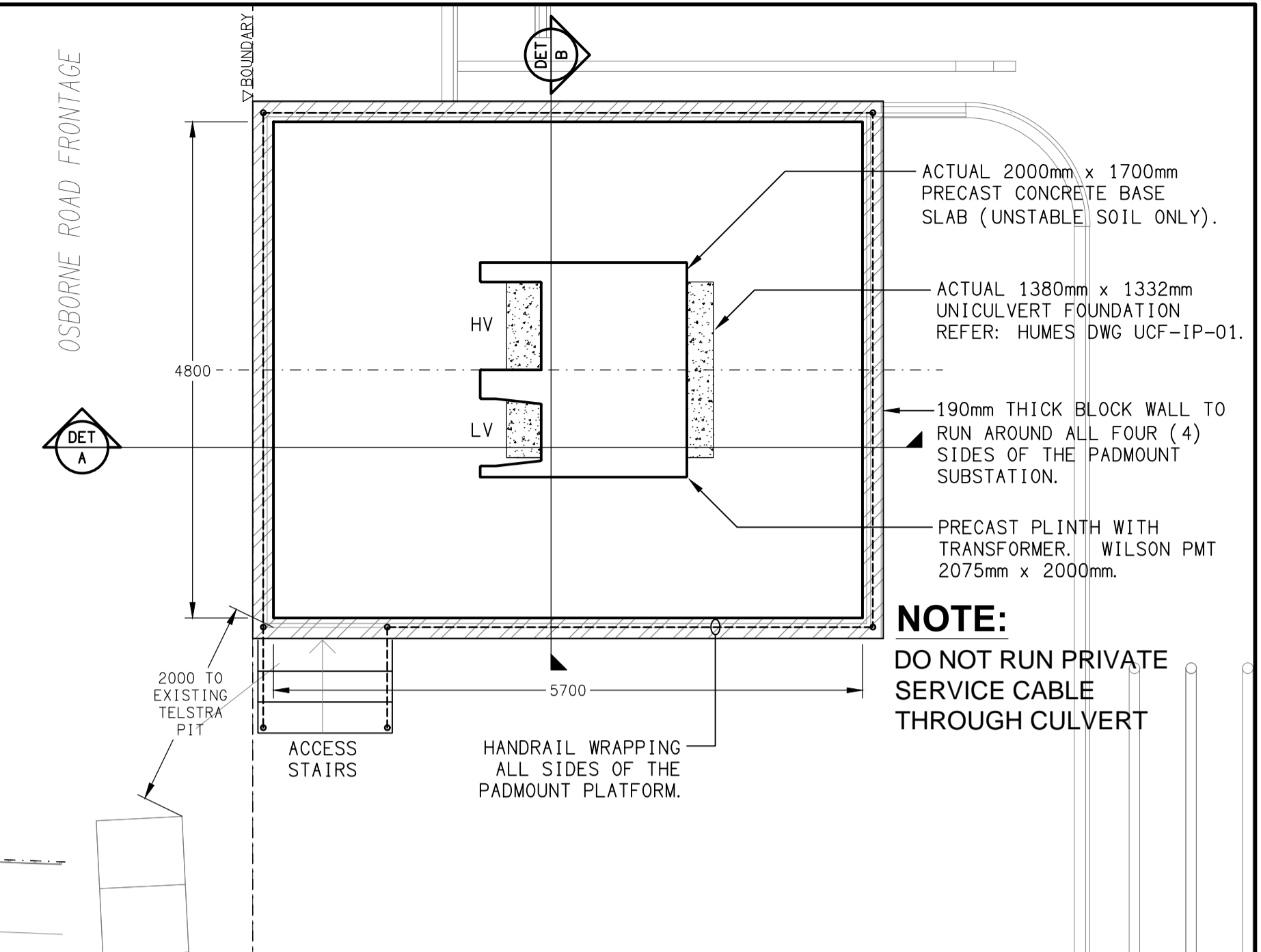

DETAIL PLAN
ENERGEX POSITIONING OF PADMOUNT ON UNICULVERT
SCALE 1:50

DIAL 1100 BEFORE YOU DIG
ALL SERVICE CHECKS TO BE REORDERED PRIOR TO ANY CONSTRUCTION WORK. EXISTING SERVICE CHECKS WERE FOR PLANNING & DESIGN PURPOSES ONLY

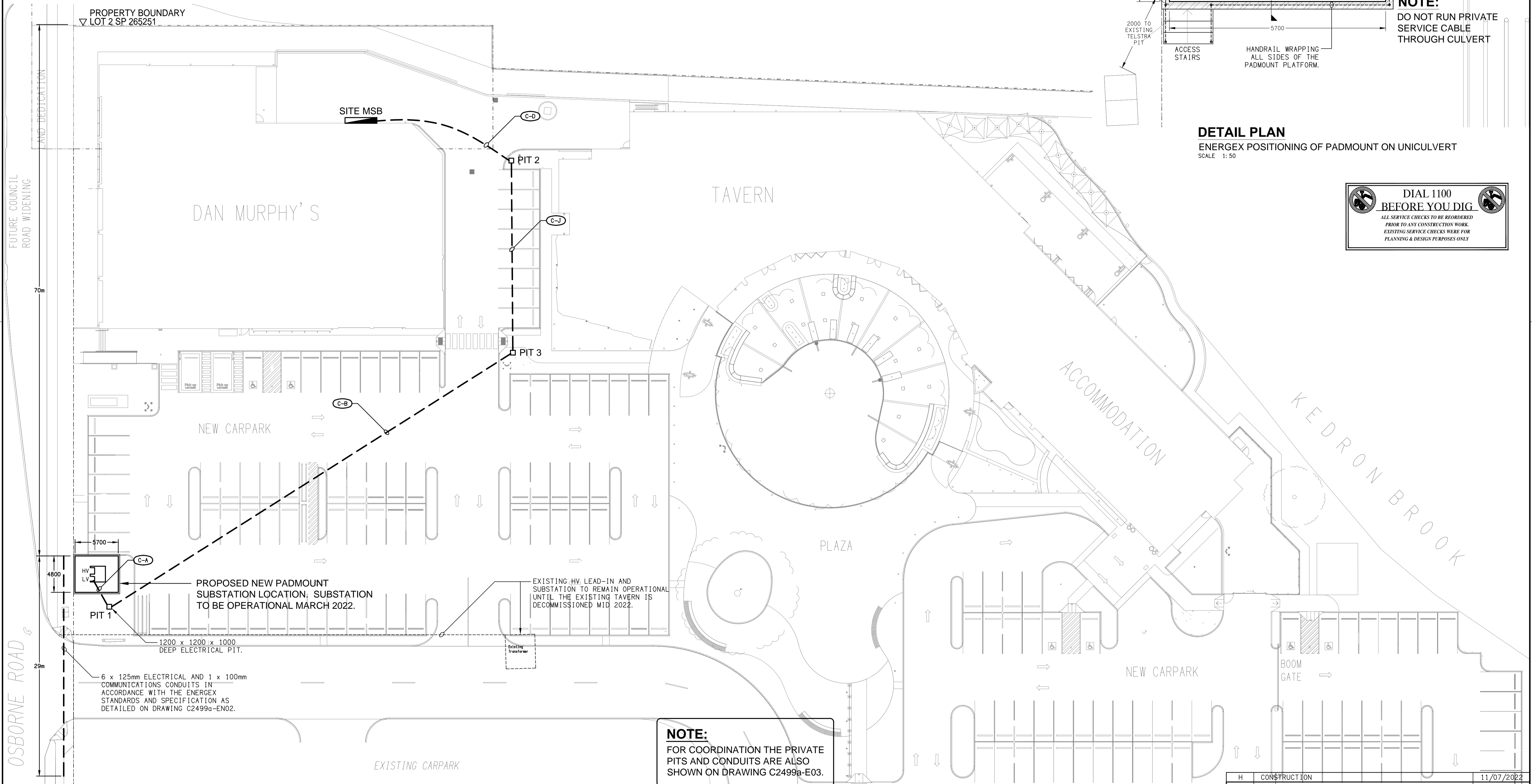

NOTE:
FOR COORDINATION THE PRIVATE PITS AND CONDUITS ARE ALSO SHOWN ON DRAWING C2499a-E03.

ELECTRICAL DESIGN GROUP BRISBANE PTY LTD ACN 092 710 793 TRADING AS: ELECTRICAL DESIGN GROUP	THE COPYRIGHT OF THIS DRAWING REMAINS THE PROPERTY OF THE ELECTRICAL DESIGN GROUP. USE FIGURED DIMENSIONS IN PREFERENCE TO SCALE. ALL DIMENSIONS TO BE VERIFIED ONSITE.	CULVERT INSPECTION REQUIRED BEFORE TRANSFORMER IS DELIVERED - 48 HOURS PRIOR NOTICE NEEDED. CONTACT _____ ON _____ TRANSFORMER WILL NOT BE ENERGISED UNTIL ALL REQUIREMENTS ARE MET.	ELECTRICAL DESIGN GROUP ELECTRICAL BUILDING SERVICES CONSULTANTS BRISBANE GOLD COAST P.O. Box 15, Sherwood Q.4075 Phone: (07) 3278 4375 Email: brisbane@edg.net.au Web: www.edg.net.au	PROJECT: THE BROOK HOTEL, MITCHELTON 167 OSBORNE ROAD, MITCHELTON	H CONSTRUCTION 11/07/2022 REV. DESCRIPTION: DATE:
					DRAWING: ELECTRICAL SERVICES PADMOUNT SUBSTATION ARRANGEMENTS SITE PLAN SCALE: 1:250 & 1:50 AT A1